

## Y-FILTER, CF8M, FLENSSET, PN16, FIG. 2461

Y-strainer, CF8M, flanged, PN16, fig. 2461



### Dimensjoner

DN 50 – DN 65

### Trykklasse

DN 50 – DN 65          PN16

### Temperaturområde

-30°C til +240°C

### Funksjon og konstruksjon

Y-filter med utskiftbar filterinnsats.

Standard maskevidde:

DN 50:            1,0 mm

DN 65:            2,0 mm

### Anvendelsesområde

Installeres i et rørsystem for å oppta urenheter som kan skade ventiler og pumper. Y-filter skal helst monteres i horisontal posisjon med filterutløpet vendt nedover, men kan også monteres vertikalt når væsken strømmer ovenfra og ned.

### Materialbeskrivelse

- |            |                         |
|------------|-------------------------|
| 1. Hus     | Syrefast stål, CF8M     |
| 2. Lokk    | Syrefast stål, CF8M     |
| 3. Sil     | Syrefast stål, AISI 316 |
| 4. Bolt    | Syrefast stål, AISI 304 |
| 6. Plugg   | Syrefast stål, AISI 316 |
| 7. Pakning | PTFE                    |

### Anslutningsformer

Flenser PN16

Bygge lengder iht. EN 558 serie 1.

### Dimensions

DN 50 – DN 65

### Pressure rating

DN 50 – DN 65          PN16

### Temperature range

-30°C to +240°C

### Features

Y-strainer with replaceable filter cartridge

### Standard mesh:

DN 50:            1,0 mm

DN 65:            2,0 mm

### Range of application

Installed in pipe systems to avoid dirt and unwanted particles damaging valves and pumps. Y-strainer should be installed in a horizontal position, bonnet down, but can also be mounted in a vertical position when the flow direction is from up to down.

### Materials

- |           |                           |
|-----------|---------------------------|
| 1. Body   | Stainless steel, CF8M     |
| 2. Cover  | Stainless steel, CF8M     |
| 3. Mesh   | Stainless steel, AISI 316 |
| 4. Bolt   | Stainless steel, AISI 304 |
| 5. Plug   | Stainless steel, AISI 316 |
| 6. Gasket | PTFE                      |

### Socket

Flanges acc. to PN16

Face to face acc. to EN 558 series 1.

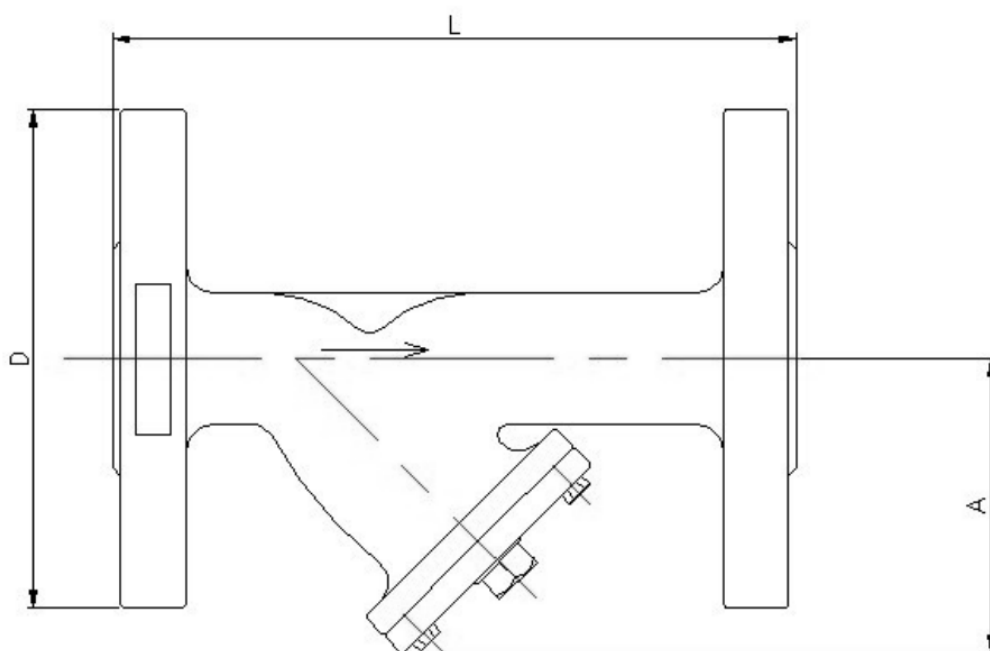

mm.

**MÅLTABELL OG ARTIKKELNUMMER/MEASUREMENTS AND PART NO.**

DN	PN	A	D	L	KG	NRF nr./Part No.
50	16	150	165	230	9,35	4015772
65	16	190	185	290	13,55	4015773