

Smartclip

A unique clamping system for floor heating

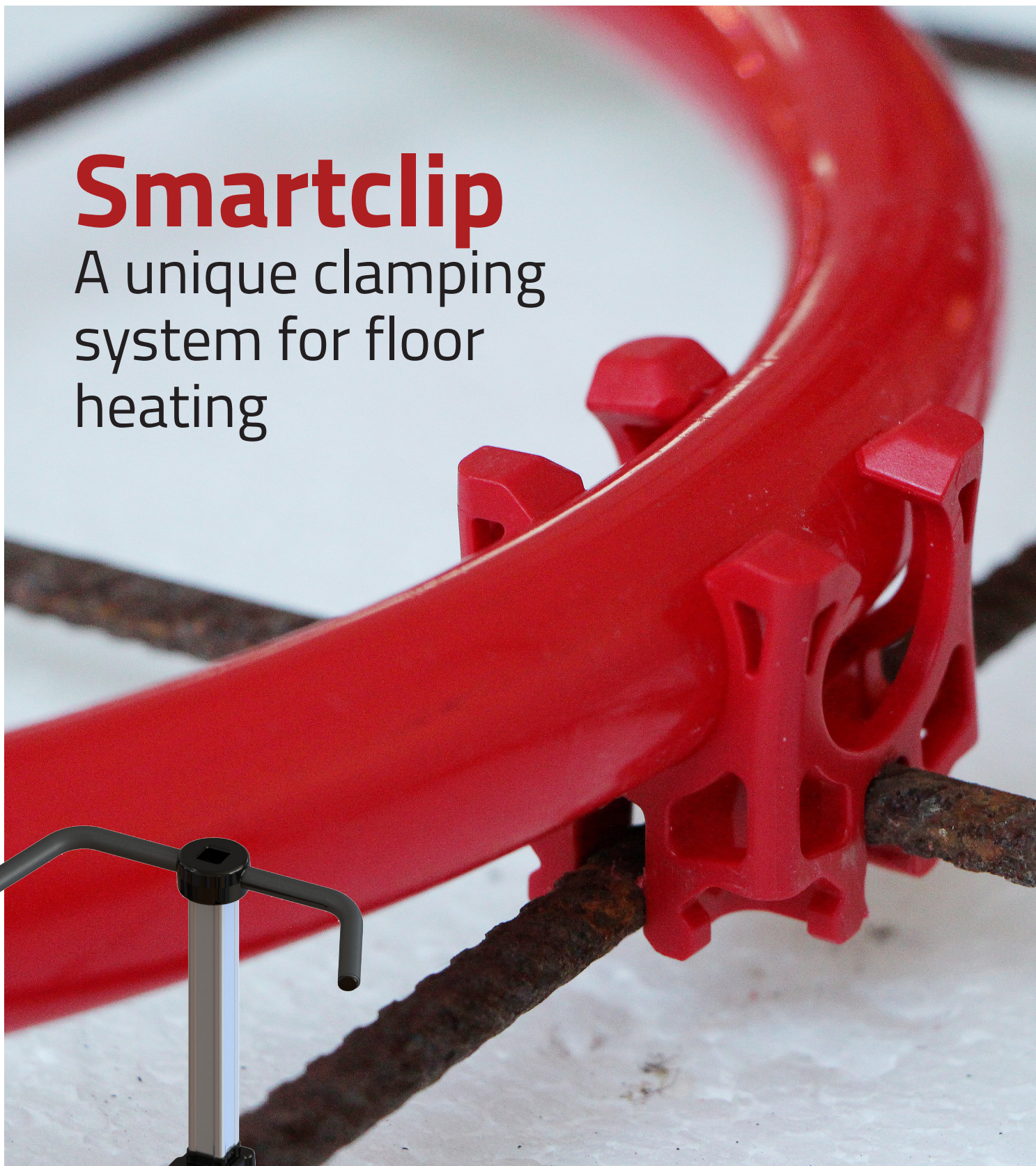

SMARTCLIP
FLOOR HEATING FIXING SYSTEM

Work smarter – not harder in a ergonomic future

We always see the bad working postures, which ruin the fingers and overstretch the knees and back. Physical overloads that in many cases end up in becoming chronic diseases. We decided to develop a new system with work environment and ergonomics being the focal points.

Product Benefits

- Height adjustable Tool - fits every employee
- Nearly 80% faster than traditional ways to mount tubes
- Only 1 employee is needed for mounting
- No more "too tight bindings"
- No risk of Corrosion (plastic on plastic)
- The Clips lifts the tube from the iron and provides better concreting
- The Clips can be kicked off and be replaced /used again
- More straight and accurate positioning of the tube on the Mesh
- Cost'nuse calculation show a breakeven with a salary of Euro 10 per hour compared to other more traditional ways to mount
- Many different types of dimensions can be delivered
- No electrical power needed
- The System will be adapted to other dimensions or needs

The Smart Tool is filled from the top with the Smart Clips gathered in a stick - when pressing down lightly above a cross on the reinforcement mesh the smartclip is mounted.



80% faster – 100% smarter

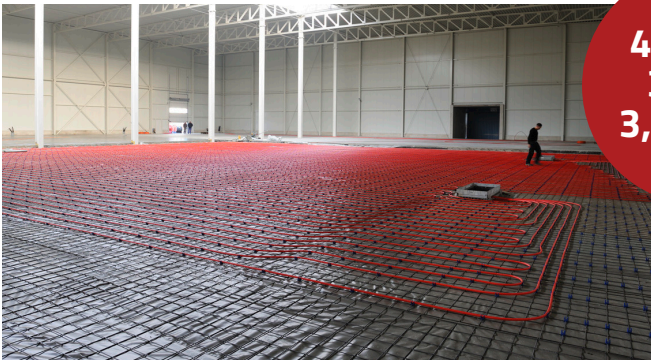

4.500 m
3 men
3,5 hours



Proff	Standard	Light
Aluminium pole	Aluminium pole	Plastic pole
Adjustable height	Rubber Handle	Plastic Handle
Rubber Handle		



Smart Clips is design-registered world wide



Product Range



SMARTCLIP
FLOOR HEATING FIXING SYSTEM

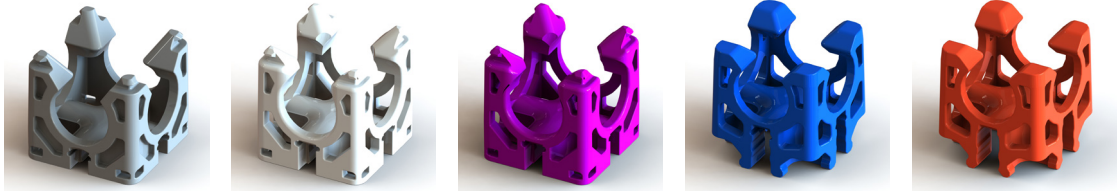

	01603	01635	01604	01605	01606
Size of wiremesh	3 mm	3,5 mm (#10)	4 mm	5 mm	6 mm
Dia. floor heating hose	16-18 mm	16-18 (1/2")	16-18 mm	16-18 mm	16-18 mm
Pcs. in box	1.408 pcs.	1.280 pcs.	1.280 pcs.	1408 pcs.	1408 pcs.
Boxes on pallets	42 pcs.	42 pcs.	42 pcs.	42 pcs.	42 pcs.
Pcs. on pallets	59.136 pcs.	53.760 pcs.	53.760 pcs.	59.136 pcs.	59.136 pcs.

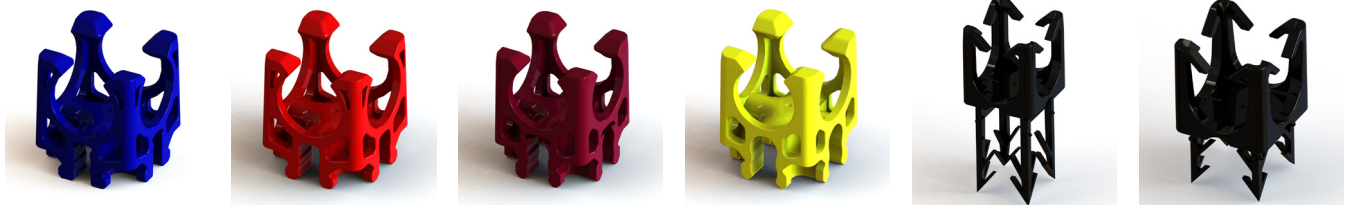

	02005	02006	02007	02008	02040	01819
Size of wiremesh	5 mm	6 mm	7 mm	8 mm	min. 40 mm insulation	min. 20 mm insulation with alu-layer
Dia. floor heating hose	20-22 mm	20-22 mm	20-22 mm	20-22 mm	16-20 mm	16-18 mm
Pcs. in box	1.280 pcs.	1.280 pcs.	1.216 pcs.	1.216 pcs.	896 pcs.	1.024 pcs.
Boxes on pallets	42 pcs.	42 pcs.	42 pcs.	42 pcs.	42 pcs.	42 pcs.
Pcs. on pallets	53.760 pcs.	53.760 pcs.	51.072 pcs.	51.072 pcs.	37.632 pcs.	42.008 pcs.
					40 mm legs	19 mm legs
					need a special tool	need a special tool

Tool

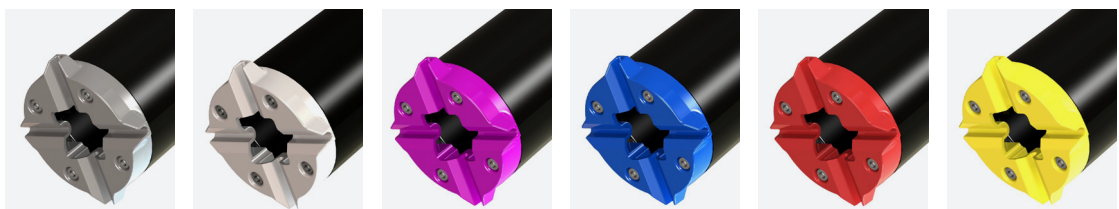

Clips	01603	01635	01604	01605/02005	01606/02006	02008
Size of wiremesh	3 mm	3,5 mm (#10)	4 mm	5 mm	6 mm	8 mm
Dia. floor heating hose	16/18 mm	16-18 mm (1/2")	16-18 mm	16-22 mm	16-22 mm	20-22 mm
Art. no. PROFF	11603	11635	11604	12005	12006	12008
Art. no. STANDARD	21603	21635	21604	22005	22006	22008
Art. no. LIGHT	31603	31635	31604	32005	32006	32008

For further information please check our website: www.smcp.dk

Same colour for tool and clips

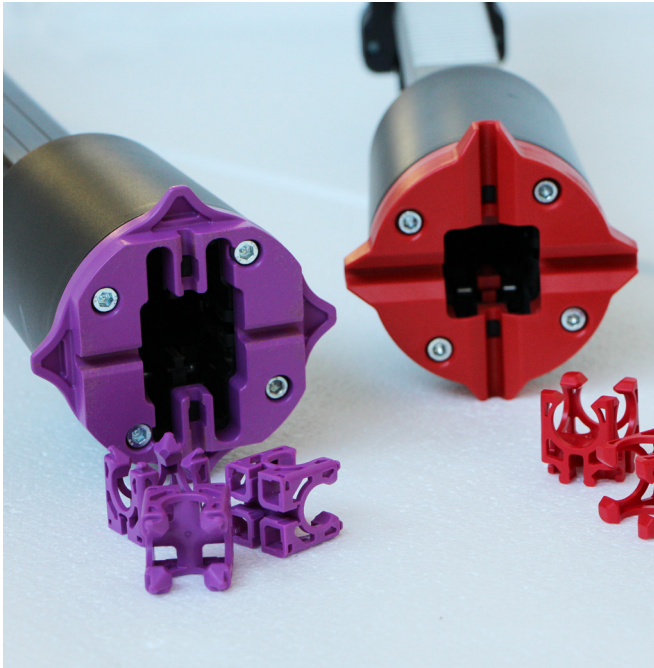



Make sure that the colour of the fixation is the same as the colour of the clip.

How to change fixating

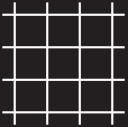

01 / Remove fixating. 02 / Place new. 03 / Tighten. 04 / Ready for use

Quick overview

		
3 mm	16/18 mm	01603
3,5 mm	16/18 mm	01635
4 mm	16/18 mm	01604
5 mm	16/18 mm	01605
5 mm	20/22 mm	02005
6 mm	16/18 mm	01606
6 mm	20/22 mm	02006
7 mm	20/22 mm	02007
8 mm	20/22 mm	02008

Upcoming products

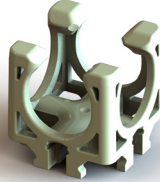
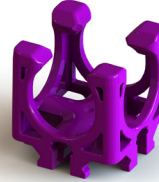
		
02003	02035	02004
3 mm	3,5 mm (#10)	4 mm
20-22 mm	19 mm (5/8")	20-22 mm
	20-22 mm (3/4")	



Contact

International sale:
René Jacobsen CCO
Phone +45 2012 3078

Mail rj@smcp.dk
Skype [rene_smcp](https://www.skype.com/profile/rene_smcp)
Fax +45 6980 4560