

# smartpanel WETWALL

Installation

10.2022

**REMEMBER ACESSOIRES**  
for correct installation:

- Sealant
- Base profile trims
- Corner profiles
- Screwes
- Wipes

**NB! You MUST read the  
entire installation instructions  
BEFORE starting work.**



[Smartpanel.no/en](https://www.smartpanel.no/en)

member of

**BYGGMA**  
group

# smartpanel WETWALL

ALWAYS seal ALL cut surfaces on the panel with Smartpanel Wetwall SEAL.

Correct installation accessories must be used for water-tight and correct installation

Acclimatise the panels for 3 days before installation.

When renovating or mounting on a wall with an existing vapour barrier, the vapour barrier must always be punctured or removed.

## Base profile

1) Base profile trim is not a requirement in dry zones, but we recommend the use of base profile trims throughout the room. The profile trim is fitted in line with the upper edge of the floor 60-80 mm. The membrane must be applied 25 mm higher than the upper edge. Behind the upper edge there must be sufficient screw fastening to the profile trim. Installation must always start in a corner.

2) Apply Smartpanel Wetwall SEAL sealant between membrane and base profile trim/upper edge before screwing the base profile trim in place. Make sure that the sealant is applied lower than the screw holes for the base profile trim. Remember to degrease the profile trims before installing.

3) Make sure that the base profile trim is level before screwing it in place. This is very important to achieve a good result.

4) Screw the base profile trim in place with the screws provided. Use the pre-drilled holes.

5) Seal the bottom edge of the base profile trim if you have tiles so that water doesn't remain on top of the tile.

Take extra care to ensure that there is sufficient sealant in corners.

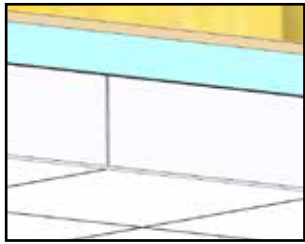

III.1  
For screw fastening to the rear wall, 18 mm Ergoboard may be used



III.2

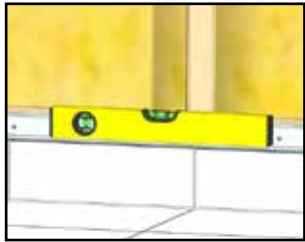

III.3

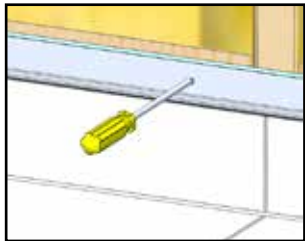

III.4



## Installation of wall panels

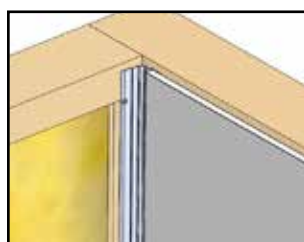

6) Illustrations showing solutions for starting at a door or an inside corner. 6b is only used for 2-pcs inner corner profiles.



III.7

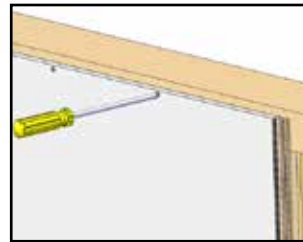

III.8



III.9

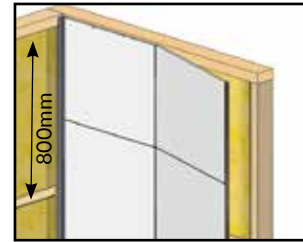

III.10

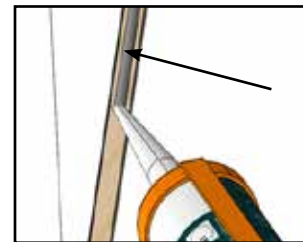

III.11

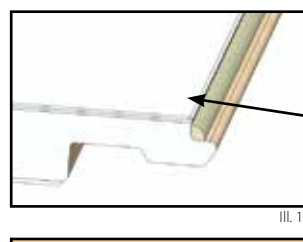

III.12

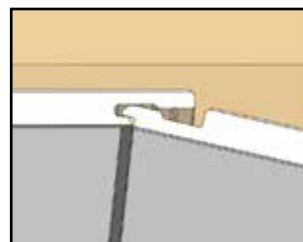

III.13

7) Screw part 1 of the inner corner profile in place. If the corner is not plumb, the panel must be adapted to the deviation. Cut the panel so that the rough edge is on the back of the panel. If the panel is too long, always cut the excess length from the top of the panel to accommodate the sill drip profile at the bottom, as well as to maintain the tile pattern.

8) Make sure the panel leveled before screwing it in at the top. Pre-drilling in the top of the panels is recommended. The panels must always be installed from left to right to ensure that they are placed drip edge down.

9) Adjust the panel so that it is in contact with the studs on the right. Make sure that the panel is plumb before installing it. Screw into the top of the panel and into the groove. Max. distance between the screws is 200 mm.

10) Click the next panel into place. Screw into the top of the panel and into the groove. Max. distance between the screws is 200 mm. The bottom screw must be 200 mm from the base profile trim.

11) If the panels are to be installed in a wet zone, apply Smartpanel Wetwall SEAL sealant in the joint. The sealant must be applied in the upper edge of the groove (as shown in the illustration). All the panel's cut surfaces must always be sealed with Smartpanel Wetwall SEAL. See illustration 22 for wet zone description.

12) Apply enough Wetwall SEAL sealant to allow the sealant to seep out over the entire length of the joint.

13) Click the panels together. Spray on Wetwall CLEAN, remove excess sealant with Smartpanel Wetwall sealing tools. Wipe clean with Smartpanel Wetwall WIPES. Continue in the same way until you come to a pipe penetration or a corner.

## Installation tips: Smartpanel WETWALL

Ideal substrates for mounting Smartpanel Wetwall are Ergoboard, chipboard, OSB etc.

If the boards are mounted on studs, extra care must be taken when mounting the boards near differences in level/stepping in the substrate. Power boxes and the like that are attached to the outside of poles must be embedded.

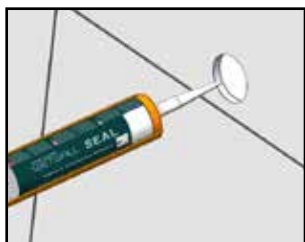

III. 14

### Pipe penetration

14) Measure out and drill holes for the pipe penetration. The hole must be 5 mm larger than the pipe itself, follow the wall box manufacturer's

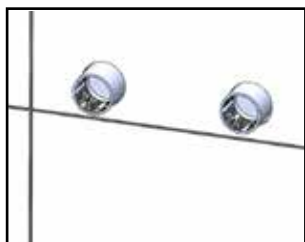

III. 15

15) When installing a wall box for a pipe-in-pipe system, check the wall box manufacturer's installation instructions.

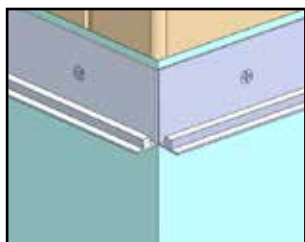

III. 16

### Outer corner

16) Make sure that the base profile trim is fitted as illustrated.

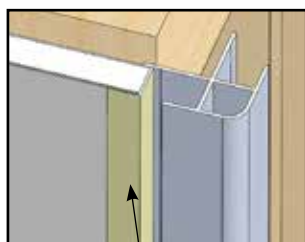

III. 17

Sealant

17) Adjust the panels to the outer corner. Press the outer corner profile onto the end panel from the first wall. If the corner is in a wet zone, Smartpanel Wetwall SEAL sealant must be applied to both sides of the profile trim before it is placed on the panel. It is important that the sealant seeps out along the entire length of the joint, between profile trim and panel.

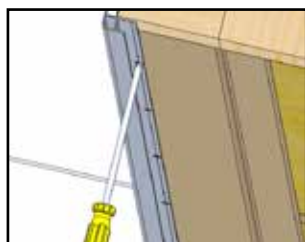

III. 18

18) Screw the profile trim to the wall, and then fasten with the screws provided with the system. Use the pre-drilled holes in the profile trim.

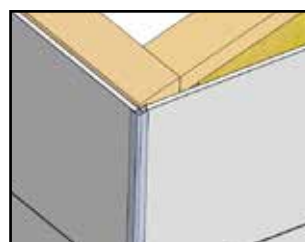

III. 19

19) Then slide the second panel into the profile trim. If the corner is in a wet zone, make sure that the sealant seeps out along the entire joint.

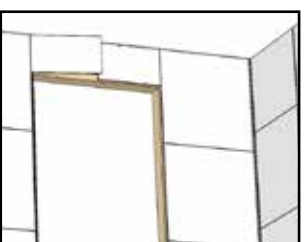

III. 20



III. 20

20) When the room is finished, the gap between the panel and the base profile trim must be sealed with Wetwall SEAL sealant. Place masking tape 2–3 mm up on the panel so that the sealant runs from the base profile trim to the outer edge of the panel. Also make sure that there is sufficient sealant where the base profile trim comes into contact with the upper edge of the flooring. Remove excess sealant.

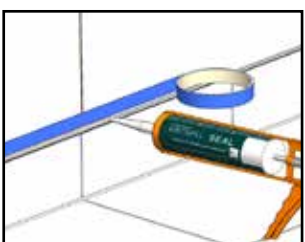

III. 20

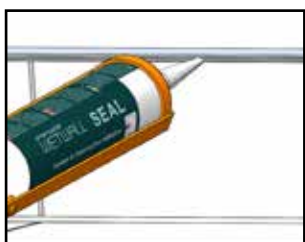

III. 22

### Joint sealing of base profile trim

21) After a few days, the sealing of the base profile trim must be checked and resealed if necessary.

All joints must be checked regularly. Carry out regular visual inspections and replace damaged or discoloured sealant with new sealant if necessary.

22) Våtromsnormen (the Norwegian trade standard for wet rooms):

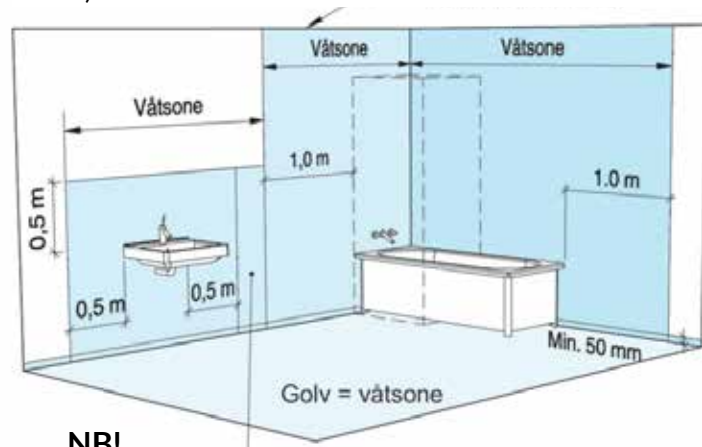

NB!

### Wetwall accessories:

### Estimate approximate use of materials

- 13 screws per panel
- 1 tube of sealant per 5 panels



For installation video and animation - visit [smartpanel.no/en](http://smartpanel.no/en) eller YouTube.



For approved installation, TEK 17 Section 13–15 "Wet rooms and rooms with water installations" must be observed. Where Wetwall is to act as a vapour barrier, the panels must be installed as in wet zones.



# smartpanel WETWALL



Producer:  
Smartpanel AS  
Habornveien 50  
1630 Gamle Fredrikstad  
Norway  
[kundeservice.smartpanel@byggma.no](mailto:kundeservice.smartpanel@byggma.no)  
[www.smartpanel.no/en](http://www.smartpanel.no/en)