

# IDD3-100-D480-A

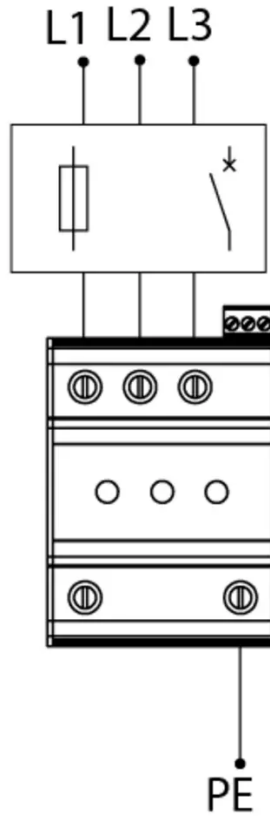

## Installation



## Mounting

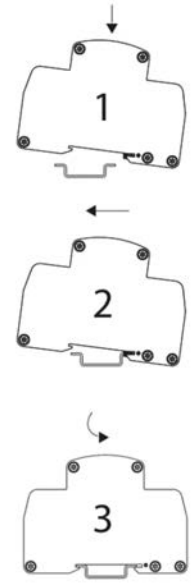

## Alarm

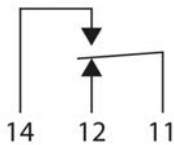

11-12 open	Power On
11-14 closed	
11-12 closed	Power Off
11-14 open	

## Terminals

Terminal Type		
min Capacity	2.5 mm <sup>2</sup>	0.5 mm <sup>2</sup>
max Capacity	16 mm <sup>2</sup>	2.5 mm <sup>2</sup>
Torque	2 Nm	0.6 Nm
Strip Length		

## Dimensions

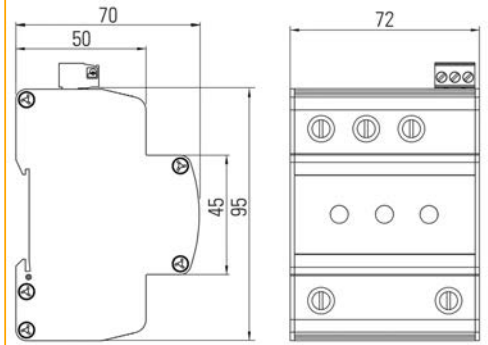

### Electrical Specifications

Connection type		Shunt
Nominal voltage	$U_0$	400VAC
Maximum backup fuse		63A
Recommended SCB		SCB1-3-80
Earth leakage current	$I_{PE}$	<math><10\mu A</math>

### Mechanical Specifications

Minimum operating temperature		-40°C
Maximum operating temperature		70°C
Minimum operating humidity		5%
Maximum operating humidity		95%
Mounting method		TS35 DIN Rail
Environmental rating		IP20