

Product No: NIT20

IPD FUSE LINK 20A 550VAC OFF-SET TAG 44.5mm FIXING 80kA AI, 401227 NIT20

FEATURES

- Fault levels up to 80kA (AC)
- Low power dissipation values
- Superior withstand to motor starting surges



General Information

Brand	IPD
Pack Quantity	10
Product Type	Bolt-In

Technical Attributes

Breaking Capacity AC (kA)	80
Breaking Capacity DC (kA)	40
Fuse Shape	Offset slotted bolted tags
Fuse Type	BS88/AI
Insulated Metal Gripping Lugs	No
Rated Current (A)	20
Rated Voltage AC (V)	550
Rated Voltage DC (V)	250
Suitable Fuse Holder	RS20 & RSM32
Utilisation Category	gG
Voltage Type	AC/DC

Physical Attributes

Maximum Ambient Temperature (°C)	40
----------------------------------	----

Dimensions

Body Diameter (mm)	14.1
--------------------	------

Fixing Centres (mm)

44.5

Protection & Standards

Standards

BS 88-2, AS 60269, IEC 269-2-1, ASTA20

Resources

Product catalogue (Flipbook)

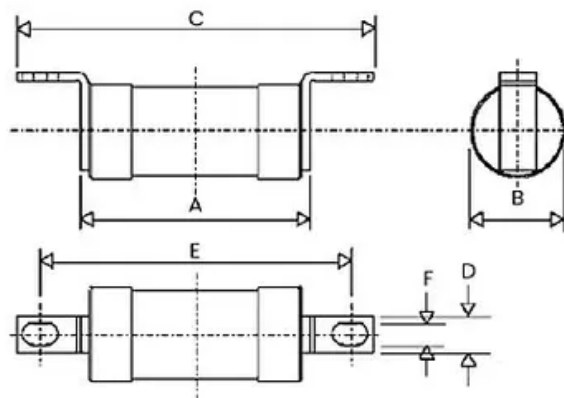
[Download from here](#)**DIMENSIONS**

A	B	C	D	E	F
36.5	14.1	55.6	11.1	44.5	4.7

All Dimensions are in "mm"