

## Product No: NIT10

### IPD FUSE LINK 10A 550VAC OFF-SET TAG 44.5mm FIXING 80kA AI, 401225 NIT10

#### FEATURES

- Fault levels up to 80kA (AC)
- Low power dissipation values
- Superior withstand to motor starting surges



#### General Information

Brand	IPD
Pack Quantity	10
Product Type	Bolt-In

#### Technical Attributes

Breaking Capacity AC (kA)	80
Breaking Capacity DC (kA)	40
Fuse Shape	Offset slotted bolted tags
Fuse Type	BS88/AI
Insulated Metal Gripping Lugs	No
Rated Current (A)	10
Rated Voltage AC (V)	550
Rated Voltage DC (V)	250
Suitable Fuse Holder	RS20 & RSM32
Utilisation Category	gG
Voltage Type	AC/DC

#### Physical Attributes

Maximum Ambient Temperature (°C)	40
----------------------------------	----

#### Dimensions

Body Diameter (mm)	14.1
--------------------	------

Fixing Centres (mm)

44.5

**Protection & Standards**

Standards

BS 88-2, AS 60269, IEC 269-2-1, ASTA20

**Resources**

Product catalogue (Flipbook)

[Download from here](#)

**DIMENSIONS**

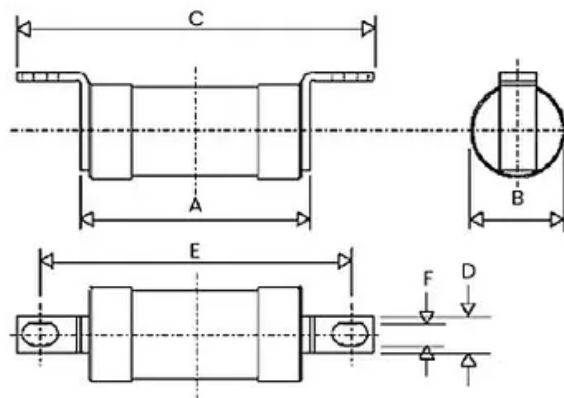

A	B	C	D	E	F
36.5	14.1	55.6	11.1	44.5	4.7

All Dimensions are in "mm"