

# CARGADOR

## 10208

# ANETA

## LIGHTING

LIGHTS FOR HOME AND WORK SINCE 1947

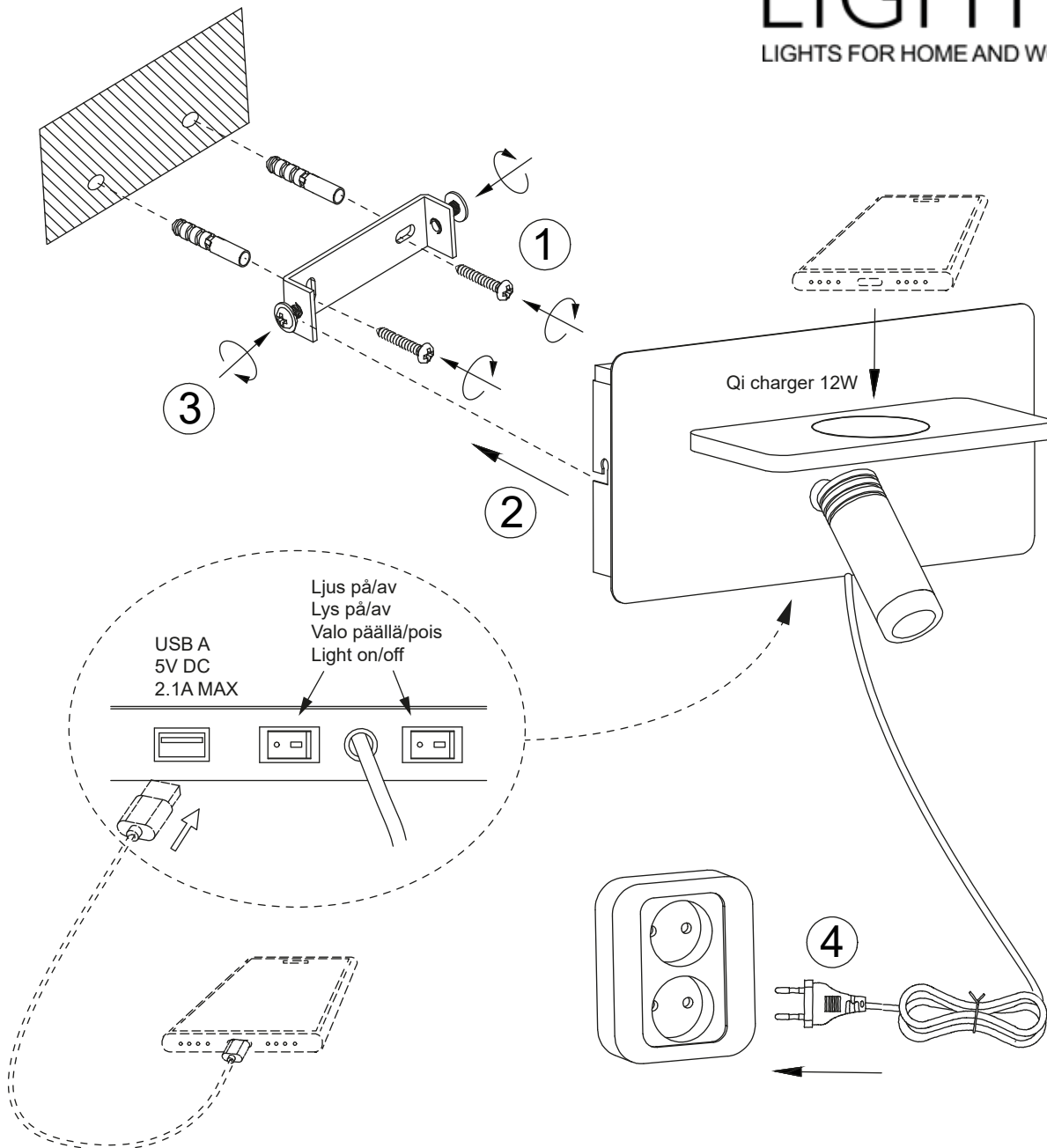

SE: Denna produkt innehåller två ljuskällor, båda med energieffektivitetsklass F. Lysdioderna i armaturen kan bytas av fackman.

50 000 tim ≈ 22 år (6 tim/dag)

NO: Dette produktet inneholder to lyskilder, begge med energieffektivitetsklasse F. Diodelyskilderne i armaturen kan byttes av fagmann.

50 000 tim ≈ 22 år (6 tim/dag)

FI: Tämä tuote sisältää kaksi valonlähdetä, molempien energiatehokkuusluokka on F. Valonlähteen saa vaihtaa vain valtuutettu sähköasentaja tai pätevytynyt alan ammattilainen.

50 000 tuntia ≈ 22 vuotta (6 t/päivä)

EN: This product contains two light sources, both of energy efficiency class F. The light sources can be replaced by a qualified person. 50 000 h ≈ 22 years (6 h/day)

Light Source data:..... Reading lamp ..... Back light

Lighting technology used:.....	LED.....	LED
Mains or non-mains:.....	non-mains.....	non-mains
Directional or non-directional:.....	non-directional.....	non-directional
Connected L.S.:.....	no.....	no
Color-tuneable:.....	no.....	no
Envelope:.....	no.....	no
High luminance:.....	no.....	no
Anti-glare shield:.....	no.....	no
Dimmable:.....	no.....	no
Energy consumption in on-mode:.....	2 kWh / 1000 h.....	5 kWh/1000h
Energy efficiency class (A-G):.....	F.....	F
Useful luminous flux:.....	173 lm *.....	515 lm *
CCT colour temperature:.....	3000 K.....	3000 K
On-mode power:.....	1.8 W.....	4.3W
Stand-by power:.....	N/A.....	N/A
Networked standby power:.....	N/A.....	N/A
CRI:.....	>80.....	>80
R9 color rendering index:.....	7.....	4
Chromaticity coordinates:.....	x:0.463, y:0.420....	x:0.463, y:0.420
SDCM:.....	< 6.....	< 6
Lifetime L <sub>70</sub> B <sub>50</sub> :.....	50 000 hours.....	50 000 hours
Lumen maintenance factor:.....	0,96.....	0,96
Survival factor:.....	0,9.....	0,9
Power supply input:.....	500mA.....	150mA

\* The luminous flux stated here is the value for the light source itself in accordance with Regulation (EU) 2019/2015. On the box the luminous flux for the lighting fitting is stated, where the light is partly absorbed by glass/glare shield/shade and parts of the fitting, why it is lower than for the light source.

SE: Rengöring: Torkas med torr trasa.

Kabeln kan ej bytas. Om kabeln på lampn blir skadad skall lampn lämnas till återvinningscentral.

NO: Rengjøring: Tørkes av med tørr klut.

Ledningen kan ikke skiftes. Hvis ledningen til lampen blir skadet må lampen leveres til gjenvinningsstasjon.

FI: Puhdistus: Pyyhi kuivalla liinalla.

Johtoa ei voi vaihtaa. Jos johto on vahingoittunut tuhoa valaisin ja toimittaja valaisin kierrätyspisteeseen.

EN: Cleaning: Wipe with a dry cloth.

The cable of this luminaire can not be replaced. If the cord is damaged the luminaire shall be left to a recycling station.

[www.aneta.se](http://www.aneta.se)

[www.aneta.no](http://www.aneta.no)